

# MODEL L-90 DIAGRAM

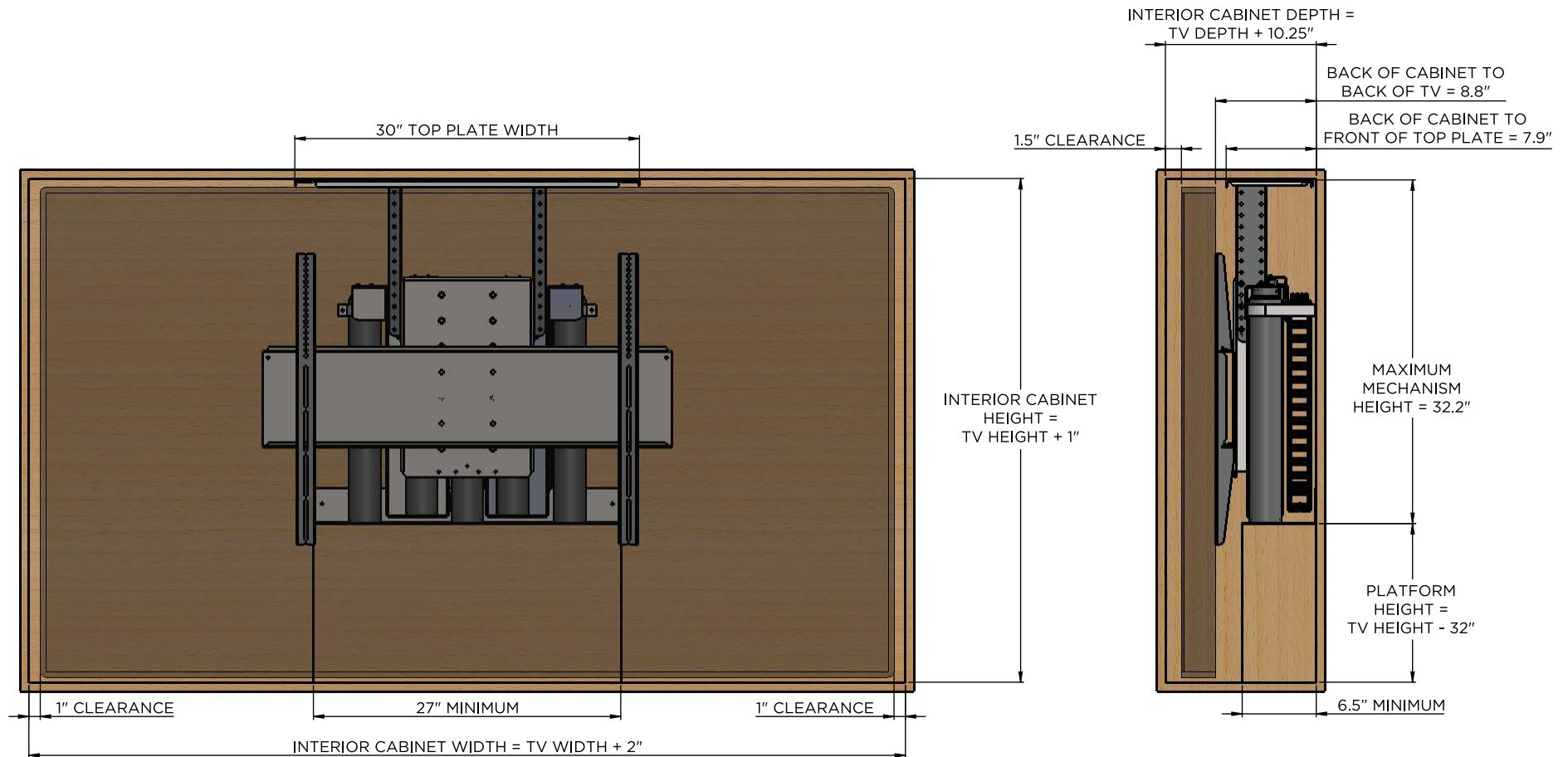

## NOTES:

1. THE CABINET BOX SHOWN IN THE DIAGRAM IS FOR REFERENCE ONLY AND IS NOT PROVIDED WITH THE LIFT SYSTEM
2. UTILIZE PLATFORM BOX TO MOUNT THE LIFT MECHANISM AS HIGH AS POSSIBLE IN THE CABINET FOR OPTIMAL RIGIDITY
3. PLATFORM BOX HEIGHT IS DEPENDANT ON THE TV HEIGHT
4. FOR THIS LIFT MODEL, THE LENGTH OF ITS TRAVEL [EXTENSION LENGTH OR STROKE] IS 50"
5. FOR THIS LIFT MODEL, THE TOTAL WEIGHT CAPACITY IS 200 LBS
6. HEIGHT OF THIS MODEL IS ADJUSTABLE IN 1/2" INCREMENTS UP TO 8" [MINIMUM HEIGHT = 24.2"; MAXIMUM HEIGHT = 32.2"]
7. LIFT ENCLOSURE'S REAR PANEL SHOULD BE CONSTRUCTED TO WITHSTAND A LOAD OF AT LEAST 600 LBS
8. LID IS DESIGNED TO FLOAT WITH PROVIDED TAPERED PINS - LID MUST BE REMOVEABLE FOR SAFETY
9. WHEN DETERMINING TV HEIGHT, ALWAYS USE MANUFACTURER SUPPLIED "TV WITHOUT STAND" HEIGHT
10. LIFT MECHANISM IS POWDERCOATED BLACK STEEL - COLORS IN DIAGRAM ARE FOR CLARITY ONLY

**nexus<sup>21</sup>**  
 CONCEALMENT SYSTEMS

COPYRIGHT 2016 - ALL RIGHTS RESERVED  
 UPDATED 01/19/16